

TUBE FITTINGS

UCFS....X....BSP – Long Female Union (Bulkhead)

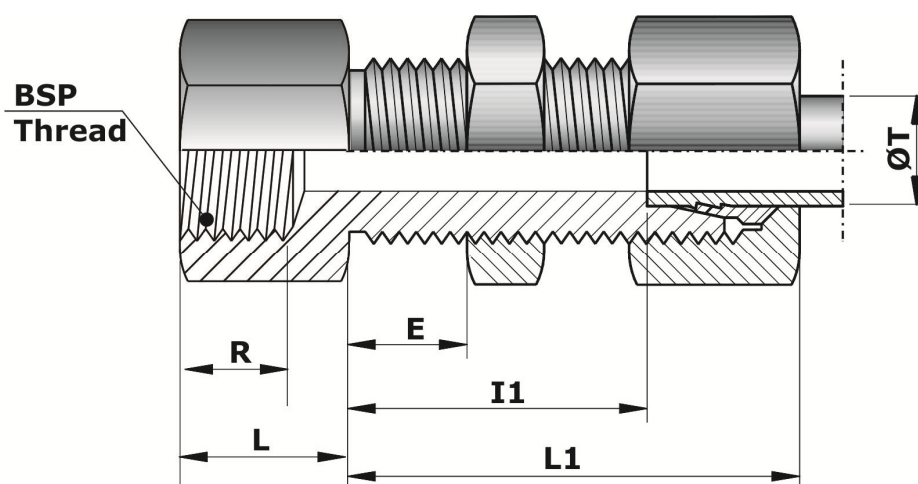

Standard - **DIN EN ISO 8434-1**

Ref.	Nominal	Ø T	BSP	R	L	I1	L1	ØF
Metric Tube	Pressure		Thread					
UCFSS 10LX1/8 BSP	315 bar	10	1/8	13	15	28	43	17
UCFSS 10LX1/4 BSP	315 bar	10	1/4	17	22	28	43	17
UCFSS 10LX1/2 BSP	315 bar	10	1/2	20	29	28	43	17
UCFSS 12SX3/8 BSP	630 bar	12	3/8	18	23	30,5	47	21
UCFSS 22LX1/2 BSP	160 bar	22	1/2	20	23	34,5	51	31
Fractional Tube								
UCFSS 9.5X1/4 BSP	630 bar	3/8'	1/4	17	22	28	50	17
UCFSS 12.7X1/2 BSP	450 bar	1/2'	1/2	23	26	29	52	21
UCFSS 19X1/2 BSP	320 bar	3/4'	1/2	23	26	33	58	29

- L1 – Approximate dimensions with nuts tightened;
- The references refer to the connections in Carbon Steel (**S**);
To order Stainless Steel (**SS**), add another "**S**" in ref. **UCFSS 10LX1/4 BSP**;
- Upon request produce any combinations of side tube with any combination of female threads. Ex. NPT, Metric, UNF, etc..
- "**E**" = Max Thickness Plate: 16 MM (5/8').
- "**F**" = Diameter drilling of plate.
- All connections are supplied complete (Nut, and ring mounted in the connection)

Note: The information contained here is subject to change without notice.

MILANO EQUIPAMENTOS HIDRÁULICOS LTDA

www.milano.ind.br - milano@milano.ind.br

