

CONEXÕES SAE - JIC (ISO 8434-2 / SAE J514)

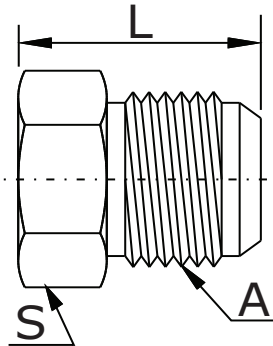

Bujão Macho 37° - JIC (37° Flare end Plug) 070109.....



Ref.	Tubo	Rosca A UNF	L	S
070109-4 C	1/4	7/16-20	20	9/16
070109-5 C	5/16	1/2-20	20	9/16
070109-6 C	3/8	9/16-18	21	5/8
070109-8 C	1/2	3/4-16	24	13/16
070109-10 C	5/8	7/8-14	28	15/16
070109-12 C	3/4	1.1/16-12	33	1.1/8
070109-14 C	7/8	1.3/16-12	33	1.1/4
070109-16 C	1	1.5/16-12	34	1.3/8
070109-20 C	1.1/4	1.5/8-12	37	1.3/4
070109-24 C	1.1/2	1.7/8-12	42	2
070109-32 C	2	2.1/2-12	52	2.3/4

Ref. em Aço Carbono (C)

1 - Materiais: **Aço Inoxidável (S) = 070109-8 S**
Latão (B) = 070109-8 B